

H20LB - Allowable Loading

SPAN		Uniformly Distributed Load		CPL		total weight
		UDL		CPL		
m	ft	kg/m	lbs/ft	kgs	lbs	
1,00	3,30	620	417,3	420	926,9	3.3
1,50	4,90	350	235,6	350	772,5	4.6
2,00	6,60	160	107,7	240	529,7	5.9
2,50	8,20	150	101,0	200	441,4	7.2
3,00	9,80	120	80,8	190	419,3	8.5
3,50	11,50	90	60,6	170	375,2	8.9
4,00	13,10	70	47,1	150	331,1	9.8
4,50	14,70	60	40,4	130	286,9	11.2
5,00	16,40	45	30,3	110	242,8	12.7

1 inch = 25,4 mm | 1m = 3.28 ft | 1 lbs = 0,453 kg

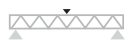

- Tüv certification only valid for loading table above.
- Loading figures are only valid for static loads.
- Loading figures are only valid for single spans with supports at both ends.
- All static systems, other than single spans, need an individual structural calculation. Please contact a structural engineer or Prolyte Group for assistance.
- Loading figures are calculated according to and in full compliance with European standards (Eurocode).
- The self-weight of the trusses is already taken into account.
- Loading figures are only valid for the cross sectional orientation of the truss as shown by the icon in the loading table.
- The interaction between bending moment and shear force at the connection point is already taken into account.
- Truss spans can be assembled from different truss lengths.
- Read the manual before assembling, using and loading the truss.